

## SDD - Studs

Self-Clinching, High-Strength, Dog Point  
Inch

Sample Part Number  
**SDDST - 1032 - .500 - Z**  
 Series/ Thread Length Finish  
 Material Code

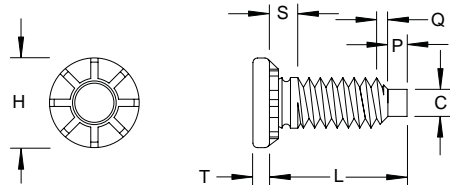

Thread	Thread Code	Sheet Thickness MIN	Hole Size in Sheet +.005/- .000	Hole in Attached Parts MAX	H ±.01	S MAX	T MAX	C ±.005	P ±.010	Q Transitional Length to Full Thread NOM	Dist. Hole C/L to Edge MIN
10 - 32	1032	.050	.190	.250	.300	.105	.040	.138	.065	.098	.415
1/4 - 20	0420	.060	.250	.312	.380	.125	.050	.173	.085	.149	.460
5/16 - 18	0518	.075	.312	.375	.480	.140	.070	.228	.105	.164	.500
3/8 - 16	0616	.090	.375	.437	.580	.155	.085	.282	.125	.182	.530

Custom sizes available.

(L) Length ±.015						
.500	.750	1.00	1.25	1.50	1.75	2.00

Material	Description	Finish	Description
ST	Carbon Steel	Z	Zinc Clear
SS	300 Series Stainless Steel	P	Passivate
PB	Phosphor Bronze	P	Passivate

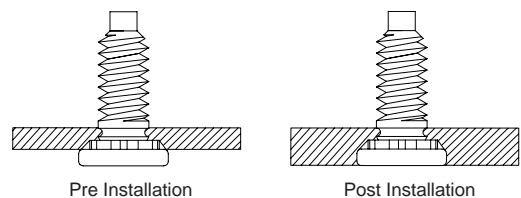

All Dimensions are in Inches

## SDD - Studs

Self-Clinching, High-Strength, Dog Point  
Metric

Sample Part Number  
**SDDST - M6 - 15 - Z**  
 Series/ Thread Length Finish  
 Material Code

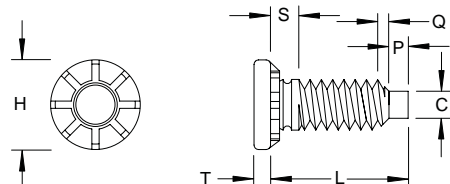

Thread	Thread Code	Sheet Thickness MIN	Hole Size in Sheet +.0.13/-0.00	Hole in Attached Parts MAX	H ±0.25	S MAX	T MAX	C ±0.13	P ±0.25	Q Transitional Length to Full Thread NOM	Dist. Hole C/L to Edge MIN
M5 x 0.8	M5	1.3	5	6.5	7.8	2.7	1.14	3.66	1.78	2.48	10.7
M6 x 1	M6	1.5	6	7.5	9.4	2.8	1.27	4.37	2.03	3.05	11.5
M8 x 1.25	M8	2	8	9.5	12.5	3.5	1.78	6.05	2.67	3.73	12.7
M10 x 1.5	M10	2.3	10	11.5	15.7	4.1	2.29	7.72	3.43	4.37	13.7

Custom sizes available.

(L) Length (mm) ±0.4						
15	20	25	30	35	40	50

Material	Description	Finish	Description
ST	Carbon Steel	Z	Zinc Clear
SS	300 Series Stainless Steel	P	Passivate
PB	Phosphor Bronze	P	Passivate

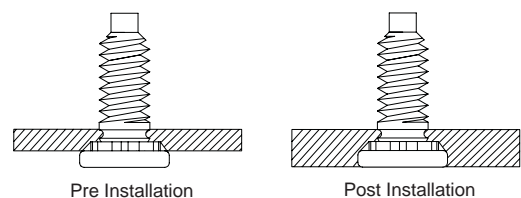

All Dimensions are in Metric