

NN - Nuts

Self-Clinching, Nylon, Locking
Inch

Sample Part Number

NNST - 632 - .060 - Z
Series/ Thread Shank Finish
Material Code

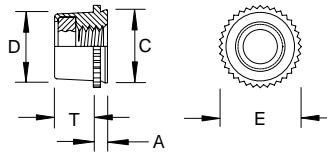

Thread	Thread Code	A Shank MAX	Sheet Thickness	Hole Size in Sheet +.003/-0.000	C MAX	D MAX	E MAX	T MAX	Dist. Hole C/L to Edge MIN	Hole in Attached Parts MAX
4 - 40	440	.060	.059-.070	.234	.233	.216	.28	.130	.17	.132
6 - 32	632	.060	.059-.070	.265	.264	.246	.31	.130	.19	.158
8 - 32	832	.060	.059-.070	.297	.296	.278	.34	.155	.22	.184
10 - 32	1032	.060	.059-.070	.312	.311	.292	.35	.165	.25	.210

Custom sizes available.

Material	Description	Finish	Description
ST	Carbon Steel	Z	Zinc Clear
SS	300 Series Stainless Steel	P	Passivate

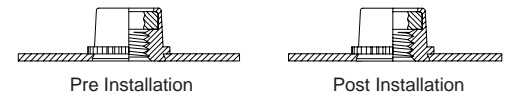

All Dimensions are in Inches

NN - Nuts

Self-Clinching, Nylon, Locking
Metric

Sample Part Number

NNST - M4 - 1.52 - Z
Series/ Thread Shank Finish
Material Code

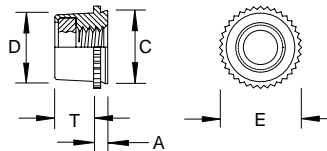

Thread	Thread Code	A Shank MAX	Sheet Thickness	Hole Size in Sheet +0.08/-0.00	C MAX	D MAX	E MAX	T MAX	Dist. Hole C/L to Edge MIN	Hole in Attached Parts MAX
M3 x 0.5	M3	1.52	1.5-1.78	6	5.97	5.5	7.1	3.6	4.3	3.5
M4 x 0.7	M4	1.52	1.5-1.78	7.5	7.47	7	8.6	4.2	5.6	4.5
M5 x 0.8	M5	1.52	1.5-1.78	8	7.97	7.5	8.9	4.5	6.4	5.5

Custom sizes available.

Material	Description	Finish	Description
ST	Carbon Steel	Z	Zinc Clear
SS	300 Series Stainless Steel	P	Passivate



All Dimensions are in Metric