

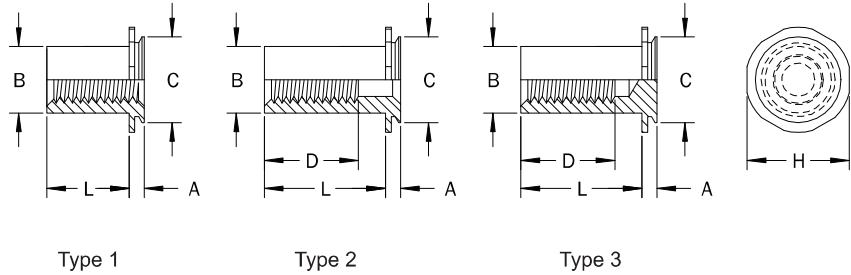

Self-Clinching, Concealed-Head, No Corners

FEATURES

- Prevent ingress of dust, gases and liquids when installed in blind milled holes.
- Concealed heads that allow opposite sides of sheets to remain smooth and unblemished.
- Install in sheets as thin as .062" using a standard press.



All dimensions in inches

PART DESCRIPTION EXAMPLE

TBST — 440 — .250 — Z
 T T T T
 Material Thread Length Finish
 Code Code Code Code

INCH	Thread	L (Length) +.002/-.005							
		4-40	.187 ¹	.250 ²	.312 ²	.375 ²	.500 ³	.625 ³	.750 ³
6-32	.187 ¹	.250 ¹	.312 ²	.375 ²	.500 ³	.625 ³	.750 ³	1.00 ³	
8-32	.187 ¹	.250 ¹	.312 ²	.375 ²	.500 ³	.625 ³	.750 ³	1.00 ³	
10-32	.187 ¹	.250 ¹	.312 ¹	.375 ¹	.500 ²	.625 ³	.750 ³	1.00 ³	
1/4-20	.187 ¹	.250 ¹	.312 ¹	.375 ¹	.500 ²	.625 ²	.750 ³	1.00 ³	

All dimensions in inches

INCH	Thread	Thread Code	Sheet				A Max.	B Max. (8)	C Max.	D Depth Full Thread Min.	H Nom.
			Min. Thickness	Blind Mounting Hole Diameter +.003 -.000	Min. Depth of Blind Hole	Min. Distance Hole Center to Edge					
	4-40	440	.062	.213	.043	.188	.041	.165	.212	.188	.250
	6-32	632	.062	.290	.043	.219	.041	.213	.289	.250	.312
	8-32	832	.062	.312	.043	.250	.041	.245	.311	.250	.344
	10-32	1032	.062	.344	.043	.281	.041	.290	.343	.375	.375
	1/4-20	0420	.062	.390	.043	.375	.041	.354	.389	.375	.438

- (1) Type 1 (2) Type 2 (3) Type 3
- (4) With Type 1 standoff the minimum thread length equals barrel length "L" and screw may not pass through shank end. Use caution when using screws with lengths exceeding "L" as they may cause the standoff to jack-out from the sheet.
- (5) With Type 2 standoffs the screw may not pass through unthreaded end. Use caution when using screws with lengths exceeding "L" as they may cause the standoff to jack-out from the sheet.
- (6) Type 3 standoff is blind.
- (7) Blind mounting holes may be deeper than the minimums shown except where sheet material thickness is at or near minimum thickness. Standoffs should be installed with flange flush with the sheet surface.
- (8) If using the standoff as a bushing, the hole in the attached part must not exceed B Max. +.020".

Material Code	Material Description	Finish Code	Finish Description	For Use in Sheet Hardness			
				HRB 50 Max.	HRB 70 Max.	HRB 80 Max.	HRB 88 Max.
ST	Heat Treated Carbon Steel	Z	Zinc (SC1) with Type III Clear Chromate per ASTM B 633			•	
SS	300-Series Stainless Steel	P	Passivated and/or tested per ASTM A 967		•		
S4	Heat Treated 400-Series Stainless Steel	P	Passivated and/or tested per ASTM A 967				•
AL	Aluminum	PLN	Plain	•			

Self-Clinching, Concealed-Head, No Corners

FEATURES

- Prevent ingress of dust, gases and liquids when installed in blind milled holes.
- Concealed heads that allow opposite sides of sheets to remain smooth and unblemished.
- Install in sheets as thin as 1.6mm using a standard press.

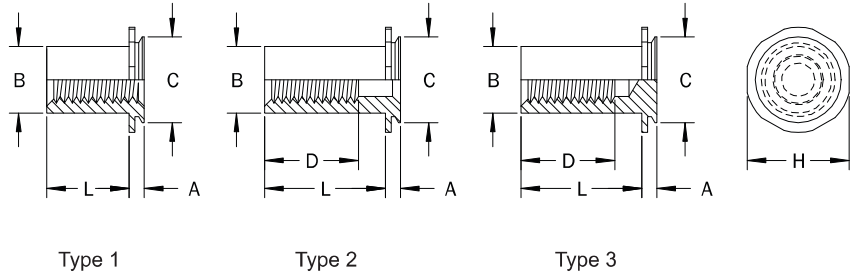

All dimensions in millimeters

PART DESCRIPTION EXAMPLE

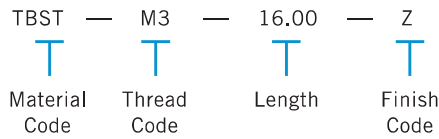

METRIC	Thread	L (Length) +0.05/-0.13							
	M3 x 0.5	4.00 ¹	6.00 ¹	8.00 ²	10.00 ³	12.00 ³	16.00 ³	20.00 ³	25.00 ³
M4 x 0.7	4.00 ¹	6.00 ¹	8.00 ²	10.00 ²	12.00 ³	16.00 ³	20.00 ³	25.00 ³	
M5 x 0.8	4.00 ¹	6.00 ¹	8.00 ¹	10.00 ²	12.00 ²	16.00 ³	20.00 ³	25.00 ³	

All dimensions in millimeters

METRIC	Thread	Thread Code	Sheet				A Max.	B Max. (8)	C Max.	D Depth Full Thread Min.	H Nom.
			Min. Thickness	Blind Mounting Hole Diameter +0.08 -0.00	Min. Depth of Blind Hole	Min. Distance Hole Center to Edge					
	M3 x 0.5	M3	1.6	5.41	1.1	4.8	1.04	4.2	5.39	5	6.35
	M4 x 0.7	M4	1.6	7.92	1.1	6.4	1.04	6.23	7.9	6.5	8.74
	M5 x 0.8	M5	1.6	8.74	1.1	7.2	1.04	7.37	8.72	9.6	9.53

- (1) Type 1 (2) Type 2 (3) Type 3
- (4) With Type 1 standoffs the minimum thread length equals barrel length "L" and screw may not pass through shank end. Use caution when using screws with lengths exceeding "L" as they may cause the standoff to jack-out from the sheet.
- (5) With Type 2 standoffs the screw may not pass through unthreaded end. Use caution when using screws with lengths exceeding "L" as they may cause the standoff to jack-out from the sheet.
- (6) Type 3 standoff is blind.
- (7) Blind mounting holes may be deeper than the minimums shown except where sheet material thickness is at or near minimum thickness. Standoffs should be installed with flange flush with the sheet surface.
- (8) If using the standoff as a bushing, the hole in the attached part must not exceed B Max. +0.51mm.

Material Code	Material Description	Finish Code	Finish Description	For Use in Sheet Hardness			
				HRB 50 Max.	HRB 70 Max.	HRB 80 Max.	HRB 88 Max.
ST	Heat Treated Carbon Steel	Z	Zinc (SC1) with Type III Clear Chromate per ASTM B 633			•	
SS	300-Series Stainless Steel	P	Passivated and/or tested per ASTM A 967		•		
S4	Heat Treated 400-Series Stainless Steel	P	Passivated and/or tested per ASTM A 967				•
AL	Aluminum	PLN	Plain	•			

Self-Clinching Standoffs