

NF - Nuts

Self-Clinching, Thin Panel

Inch

Sample Part Number

NFSS - 440 - .024 - P

Series/ Thread Shank Finish
Material Code

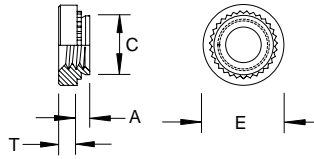

Thread	Thread Code	A Shank MAX	Sheet Thickness MIN	Hole Size in Sheet +.003/- .000	C MAX	E ±.010	T ±.010	Dist. Hole C/L to Edge MIN
2 - 56	256	.024	.025	.136	.135	.220	.065	.145
4 - 40	440	.024	.025	.166	.165	.220	.065	.170
6 - 32	632	.024	.025	.187	.186	.252	.065	.200

Custom sizes available.

Material	Description	Finish	Description
ST	Carbon Steel	Z	Zinc Clear
SS	300 Series Stainless Steel	P	Passivate

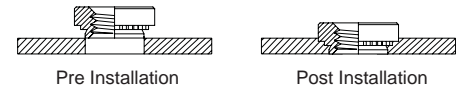

All Dimensions are in Inches

NF - Nuts

Self-Clinching, Thin Panel

Metric

Sample Part Number

NFST - M3 - 0.61 - P

Series/ Thread Shank Finish
Material Code

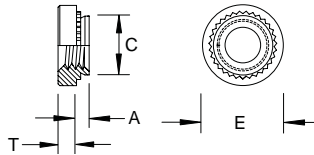

Thread	Thread Code	A Shank MAX	Sheet Thickness MIN	Hole Size in Sheet +0.08	C MAX	E ±0.25	T ±0.25	Dist. Hole C/L to Edge MIN
M2.5 x 0.45	M2.5	0.61	0.64	3.8	3.79	5.6	1.4	3.7
M3 x 0.5	M3	0.61	0.64	4.24	4.22	5.6	1.4	4.3
M3.5 x 0.6	M3.5	0.61	0.64	4.75	4.73	6.4	1.4	5.1

Custom sizes available.

Material	Description	Finish	Description
ST	Carbon Steel	Z	Zinc Clear
SS	300 Series Stainless Steel	P	Passivate

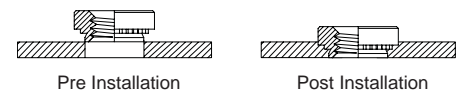

All Dimensions are in Metric