



# Female Thread Guide Pins

## FEATURES

- Precisely align stacked and/or mating panels and chasses.
- Female thread design allows for flexibility in mating male thread fastener selection.
- Wide range of thread sizes, pin diameters and lengths accommodates most alignment requirements. Custom sizes available by request.
- See PENCOM GR guide pin nuts for a complete alignment solution.
- Choice of RoHS compliant materials and finishes.



## PART DESCRIPTION EXAMPLE

GFST — M3 — 12 — Z  
 T T T T  
 Material Code Size Code Length Code Finish Code

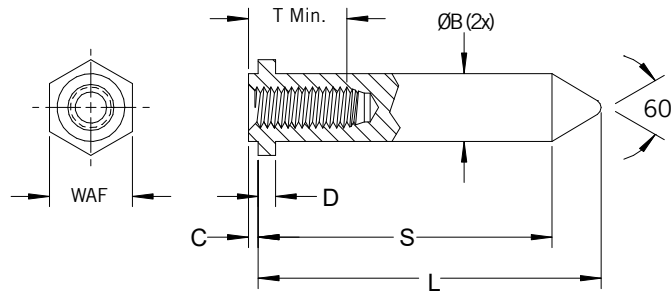

All dimensions in inches

## GENERAL

INCH	Size Code	Thread	Sheet		ØB +0.000 -0.003	C Max.	D Nom.	WAF Nom.
			Minimum Thickness	Hole Size +0.003 -0.000				
	256	2-56	.030	.119	.118	.028	.050	.156
	440	4-40	.030	.158	.157	.028	.050	.187
	632	6-32	.030	.197	.196	.028	.050	.219
	832	8-32	.030	.236	.235	.028	.050	.250

All dimensions in millimeters

METRIC	Size Code	Thread	Sheet		ØB +0.00 -0.08	C Max.	D Nom.	WAF Nom.
			Minimum Thickness	Hole Size +0.08 -0.00				
	M3	M2 x 0.4	0.76	3.02	3.00	0.71	1.27	3.97
	M4	M3 x 0.5	0.76	4.01	3.99	0.71	1.27	4.76
	M5	M3.5 x 0.6	0.76	5.00	4.98	0.71	1.27	5.56
	M6	M4 x 0.7	0.76	5.99	5.97	0.71	1.27	6.35

GF Female Thread Guide Pins

### LENGTH-60° POINT

All dimensions in inches

INCH	Size Code	L (Length Code) +.000/-.010						
		.250	.312	.375	.437	.562	.750	1.000
	S Ref. / T Min.							
	256	.177/.132	.239/.160	.302/.160	.364/.160	.489/.160	.677/.160	.927/.160
	440	.144/.100	.206/.162	.269/.225	.331/.235	.456/.235	.644/.235	.894/.235
	632	—	.170/.132	.233/.195	.295/.257	.420/.275	.608/.275	.858/.275
	832	—	.137/.113	.200/.176	.262/.238	.387/.312	.575/.312	.825/.312

All dimensions in millimeters

METRIC	Size Code	L (Length Code) +0.00/-0.25						
		6	8	10	12	15	20	25
	S Ref. / T Min.							
	M3	4.15/3.27	6.15/4.06	8.15/4.06	10.15/4.06	13.15/4.06	18.15/4.06	23.15/4.06
	M4	3.30/2.27	5.30/4.27	7.30/5.97	9.30/5.97	12.30/5.97	17.30/5.97	22.30/5.97
	M5	—	4.40/3.78	6.40/5.78	8.40/6.99	11.40/6.99	16.40/6.99	21.40/6.99
	M6	—	3.55/3.24	5.55/5.24	7.55/7.24	10.55/7.92	15.55/7.92	20.55/7.92



GF Guide Pins are offered with a 30° point angle to improve mating hole engagement. To specify, insert *30DEG* at the end of the part description.

Ex: GFST-M3-12-Z-*30DEG*

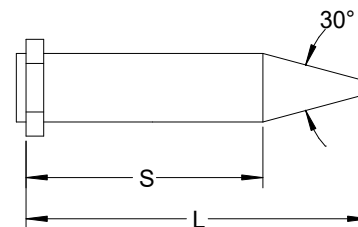

### LENGTH-30° POINT

All dimensions in inches

INCH	Size Code	L (Length Code) +.000/-.010						
		.312	.375	.437	.562	.750	1.000	1.187
	S Ref. / T Min.							
	256	.135/.107	.198/.160	.260/.160	.385/.160	.573/.160	.823/.160	1.010/.160
	440	—	.139/.122	.201/.184	.326/.235	.514/.235	.764/.235	.951/.235
	632	—	—	.142/.142	.267/.267	.455/.275	.705/.275	.892/.275
	832	—	—	—	.208/.227	.396/.312	.646/.312	.833/.312

GF Female Thread Guide Pins

### LENGTH-30° POINT (CONTINUED)

All dimensions in millimeters

METRIC	Size Code	L (Length Code) +0.00/-0.25						
		8	10	12	15	20	25	30
	S Ref. / T Min.							
M3	3.50/3.19	5.50/4.06	7.50/4.06	10.50/4.06	15.50/4.06	20.50/4.06	25.50/4.06	
M4	—	4.00/3.35	6.00/5.35	9.00/5.97	14.00/5.97	19.00/5.97	24.00/5.97	
M5	—	—	4.50/4.68	7.50/6.99	12.50/6.99	17.50/6.99	22.50/6.99	
M6	—	—	—	6.00/6.86	11.00/7.92	16.00/7.92	21.00/7.92	

### MATERIAL & FINISH

Material Code	Material Description	Finish Code	Finish Description
ST	Carbon Steel	Z	Zinc (SC1) with Type III Clear Chromate per ASTM B633
SS	300-Series Stainless Steel	P	Passivated and/or tested per ASTM A967

### TECHNICAL DATA

INCH	Size Code	Thread	Screw Installation Torque <sup>1</sup> (in-lbs)	Thread Engagement Min. <sup>1</sup> (in)
	256	2-56	1.9-2.6	.086
	440	4-40	4.0-5.5	.112
	632	6-32	7-10	.138
	832	8-32	14-19	.164

METRIC	Size Code	Thread	Screw Installation Torque <sup>1</sup> (N-m)	Thread Engagement Min. <sup>1</sup> (mm)
	M3	M2 x 0.4	0.14-0.19	2.0
	M4	M3 x 0.5	0.51-0.69	3.0
	M5	M3.5 x 0.6	0.8-1.1	3.5
	M6	M4 x 0.7	1.2-1.6	4.0

(1) Installation torques and thread engagements are for zinc-plated Grade 2 carbon steel screws used with zinc-plated carbon steel guide pins and for reference only. PENCOM recommends testing in the application.

(1) Installation torques and thread engagements are for zinc-plated Class 4.8 carbon steel screws used with zinc-plated carbon steel guide pins and for reference only. PENCOM recommends testing in the application.



Integral pilot spigot accurately positions guide pin in the sheet hole.