

# HSST - Mechanical Standoff

## Hex Swage Standoff

Inch

Sample Part Number

RSST3/16 - 256 x .125 - A - STL - Z

Series WAF Thread Length Panel Material Finish  
Code

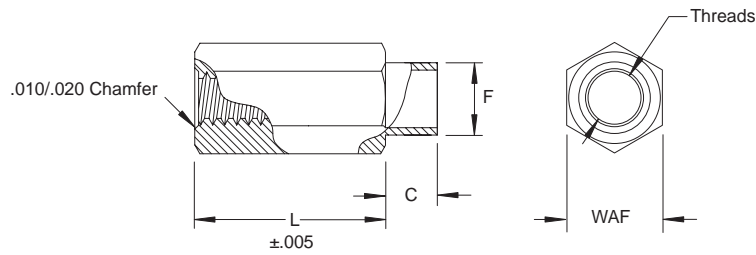

| Thread | WAF Width Across Flats |      |     |      |     |
|--------|------------------------|------|-----|------|-----|
|        | 5/32                   | 3/16 | 1/4 | 5/16 | 3/8 |
| 2-56   |                        |      |     |      |     |
| 3-48   |                        |      |     |      |     |
| 4-40   |                        |      |     |      |     |
| 6-32   |                        |      |     |      |     |
| 8-32   |                        |      |     |      |     |

Custom sizes available.

| F Shank Diameter<br>+.000<br>-.003 | F Shank Diameter |      |     |      |     |
|------------------------------------|------------------|------|-----|------|-----|
|                                    | 5/32             | 3/16 | 1/4 | 5/16 | 3/8 |
| .126                               |                  |      |     |      |     |
| .139                               |                  |      |     |      |     |
| .145                               |                  |      |     |      |     |
| .188                               |                  |      |     |      |     |
| .209                               |                  |      |     |      |     |
| .234                               |                  |      |     |      |     |

| Panel Thickness | C Shank Length<br>±.003 | Panel Code |
|-----------------|-------------------------|------------|
| 1/32            | .075                    | A          |
| 1/16            | .105                    | B          |
| 3/32            | .135                    | C          |
| 1/8             | .165                    | D          |

| L Length |
|----------|
| .125     |
| .167     |
| .250     |
| .312     |
| .375     |
| .437     |
| .500     |
| .562     |
| .625     |
| .678     |
| .750     |
| .812     |
| .875     |
| .937     |
| 1.000    |
| 1.125    |
| 1.187    |
| 1.312    |
| 1.376    |
| 1.312    |
| 1.437    |
| 1.500    |
| 1.582    |
| 1.625    |
| 1.687    |
| 1.750    |
| 1.812    |
| 1.875    |
| 1.937    |
| 2.000    |

| Material | Description                |
|----------|----------------------------|
| STL      | Carbon Steel               |
| SS       | 300 Series Stainless Steel |
| AL       | Aluminum                   |
| BR       | Brass                      |

| Finish    | Description            |
|-----------|------------------------|
| Z         | Zinc - Clear Chromate  |
| Z-BLK     | Zinc - Black Chromate  |
| Z-YEL     | Zinc - Yellow Chromate |
| NI        | Nickel                 |
| BLK-OX    | Blk Oxide              |
| ALOD      | Alodine                |
| ALOD-GOLD | Alodine Gold           |
| P         | Passivate              |
| PLN       | Plain                  |
| TIN       | Tin (Soldering)        |

Custom finishes available.

# HSST - Mechanical Standoff

Hex Swage Standoff  
Metric

Sample Part Number

HSST4.5 - M2.5 x 3 - A - STL - Z  
Series WAF Thread Thread Panel Material Finish  
 Code

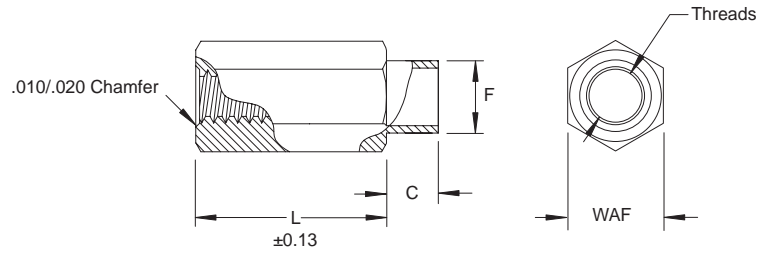

| Thread      | WAF Width Across Flats |        |        |        |
|-------------|------------------------|--------|--------|--------|
|             | 4.5                    | 6      | 8      | 10     |
| M2.0 x 0.4  | Shaded                 |        |        |        |
| M2.5 x 0.45 | Shaded                 |        |        |        |
| M3.0 x 0.5  |                        | Shaded |        |        |
| M3.5 x 0.6  |                        | Shaded |        |        |
| M4.0 x 0.7  |                        |        | Shaded |        |
| M5.0 x 0.8  |                        |        |        | Shaded |

Custom sizes available.

| Panel Thickness | C Shank Length ±.08 | Panel Code | F Shank Diameter +.00/-.08 |
|-----------------|---------------------|------------|----------------------------|
| .8              | 1.9                 | A          | 4.5 - 3.53                 |
| 1.6             | 2.7                 | B          | 6 - 4.78                   |
| 2.4             | 3.4                 | C          | 8 - 5.94                   |
| 3.2             | 3.2                 | D          | 10 - 5.94                  |

| L Length |
|----------|
| 3        |
| 4        |
| 5        |
| 6        |
| 8        |
| 10       |
| 11       |
| 12       |
| 13       |
| 14       |
| 16       |
| 19       |
| 20       |
| 22       |
| 25       |

| Material | Description                |
|----------|----------------------------|
| STL      | Carbon Steel               |
| SS       | 300 Series Stainless Steel |
| AL       | Aluminum                   |
| BR       | Brass                      |

| Finish    | Description            |
|-----------|------------------------|
| Z         | Zinc - Clear Chromate  |
| Z-BLK     | Zinc - Black Chromate  |
| Z-YEL     | Zinc - Yellow Chromate |
| NI        | Nickel                 |
| BLK-OX    | Blk Oxide              |
| ALOD      | Alodine                |
| ALOD-GOLD | Alodine Gold           |
| P         | Passivate              |
| PLN       | Plain                  |
| TIN       | Tin (Soldering)        |

Custom finishes available.

All Dimensions are in Metric

For Promotional Use Only!