

SBD - Studs

Self-Clinching, Flush-Head, Dog Point

Inch

Sample Part Number

SBDSS - 632 - .625 - P

Series/ Thread Length Finish
Material Code

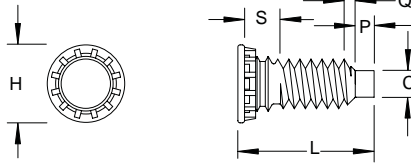

Thread	Thread Code	Sheet Thickness MIN	Hole Size in Sheet +.300/.000	Hole in Attached Parts MAX	H $\pm .015$	S MAX	C $\pm .005$	P $\pm .010$	Q Transitional Length to Full Thread NOM	Dist. Hole C/L to Edge MIN
6 - 32	632	.040	.137	.160	.206	.090	.086	.050	.098	.250
8 - 32	832	.040	.163	.185	.237	.090	.111	.055	.099	.281
10 - 24	1024	.040	.189	.210	.256	.100	.124	.065	.127	.281
10 - 32	1032	.040	.189	.210	.256	.100	.138	.065	.098	.281
1/4 - 20	0420	.062	.249	.270	.337	.135	.173	.085	.149	.312
5/16 - 18	3118	.093	.311	.333	.376	.160	.228	.105	.164	.375

Material	Description	Finish	Description
ST	Carbon Steel	Z	Zinc Clear
SS	300 Series Stainless Steel	P	Passivate
S4	400 Series Stainless Steel	P	Passivate
AL	Aluminum	PLN	Plain

Custom sizes available.

(L) Length $\pm .015$									
.250	.312	.375	.500	.625	.750	8.75	1.00	1.25	1.50

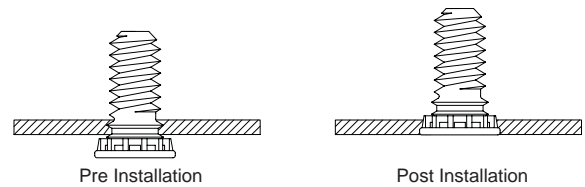

All Dimensions are in Inches

SBD - Studs

Self-Clinching, Flush-Head, Dog Point

Metric

Sample Part Number

SBDSS - M4 - 20 - P

Series/ Thread Length Finish
Material Code

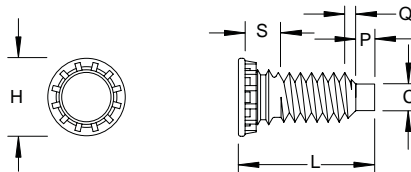

Thread	Thread Code	Sheet Thickness MIN	Hole Size in Sheet +0.08/-0.00	Hole in Attached Parts MAX	H ± 0.4	S MAX	C ± 0.13	P ± 0.25	Q Transitional Length to Full Thread NOM	Dist. Hole C/L to Edge MIN
M3.5 x 0.6	M3.5	1	3.5	4.1	5.3	2.25	2.4	1.27	1.88	6.4
M4 x 0.7	M4	1	4	4.6	5.9	2.4	2.79	1.4	2.26	7.2
M5 x 0.8	M5	1	5	5.6	6.5	2.7	3.66	1.78	2.48	7.2
M6 x 1	M6	1.6	6	6.6	8.2	3	4.37	2.03	3.05	7.9
M8 x 1.25	M8	2.4	8	8.6	9.6	3.7	6.05	2.67	3.73	9.6

Custom sizes available.

(L) Length (mm) ± 0.4										
6	8	10	12	15	18	20	25	30	35	

Material	Description	Finish	Description
ST	Carbon Steel	Z	Zinc Clear
SS	300 Series Stainless Steel	P	Passivate
S4	400 Series Stainless Steel	P	Passivate
AL	Aluminum	PLN	Plain

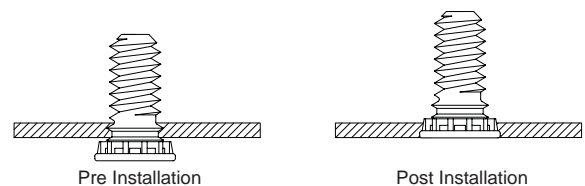

All Dimensions are in Metric

50