

## NH - Nuts

Self-Clinching, Miniature, Non-Locking  
Inch

Sample Part Number

NHSS - 632 - .040 - P

Series/ Thread Shank Finish  
Material Code

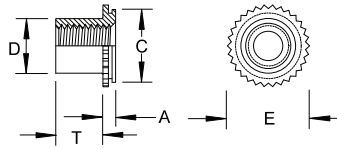

Thread	Thread Code	A Shank MAX	Sheet Thickness	Hole Size in Sheet +.003/-0.00	C +.000/-0.005	D MAX	E ±.005	T +.015/-0.00	Dist. Hole C/L to Edge MIN	Hole in Attached Parts MAX
0 - 80	080	.020	.019-.022	.110	.1095	.076	.125	.050	.09	.080
1 - 64	167	.020	.019-.022	.110	.1095	.090	.125	.050	.09	.093
2 - 56	265	.020	.019-.022	.144	.1435	.106	.160	.065	.11	.106
		.031	.030-.036							
4 - 40	440	.040	.039-.045	.172	.171	.145	.192	.065	.14	.132
		.060	.059-.070							
6 - 32	632	.040	.039-.045	.213	.212	.180	.244	.075	.17	.158
		.060	.059-.070							
8 - 32	832	.040	.039-.045	.290	.289	.215	.322	.090	.20	.184
		.060	.059-.070							
10 - 32	1032	.040	.039-.045	.290	.289	.245	.322	.110	.20	.210
		.060	.059-.070							
1/4 - 20	2520	.060	.059-.070	.344	.343	.318	.384	.120	.28	.270
1/4 - 28	2528									

Custom sizes available.

Material	Description	Finish	Description
SS	300 Series Stainless Steel	P	Passivate

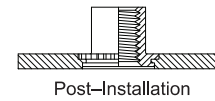
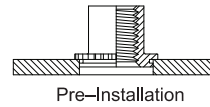

Revd. 06/1/11 All Dimensions are in Inches

## NH - Nuts

Self-Clinching, Miniature, Non-Locking  
Metric

Sample Part Number

NHSS - M3 - 1.53 - P

Series/ Thread Shank Finish  
Material Code

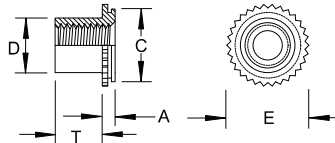

Thread	Thread Code	A Shank MAX	Sheet Thickness	Hole Size in Sheet +0.08/-0.00	C +0.00 -0.13	D MAX	E ±0.13	T +0.4/-0.0	Dist. Hole C/L to Edge MIN	Hole in Attached Parts MAX
M2 x 0.4	M2	0.76	0.76-0.91	3.61	3.6	2.5	4.07	1.65	2.8	2.5
M3 x 0.5	M3	1.02	0.99-1.14	4.39	4.37	3.96	4.88	1.9	3.6	3.5
		1.53	1.5-1.78							
M4 x 0.7	M4	1.02	0.99-1.14	7.39	7.37	5.23	8.17	2.55	5.2	4.5
		1.53	1.5-1.78							
M5 x 0.8	M5	1.02	0.99-1.14	7.39	7.37	6.48	8.17	3.05	5.2	5.5
		1.53	1.5-1.78							
M6 x 1	M6	1.53	1.5-1.78	8.74	8.72	7.72	9.74	3.3	7.1	6.5

Custom sizes available.

Material	Description	Finish	Description
SS	300 Series Stainless Steel	P	Passivate

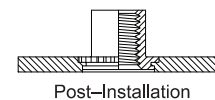
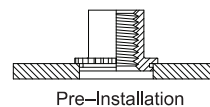

42

All Dimensions are in Metric