

NEL - Nuts

Self-Clinching, Locknut
Inch

Sample Part Number

NELST - 440 - .038 - Z
Series/ Thread Shank Finish
Material Code

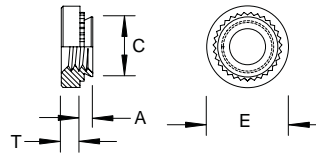

Thread	Thread Code	A Shank MAX	Sheet Thickness MIN	Hole Size in Sheet +.003/- .000	C MAX	E ±.010	T ±.010	Dist. Hole C/L to Edge MIN
4 - 40	440	.038	.040	.166	.165	.250	.070	.190
		.054	.056					
6 - 32	632	.038	.040	.1875	.187	.280	.070	.220
		.054	.056					
8 - 32	832	.038	.040	.213	.212	.310	.090	.270
		.054	.056					
10 - 32	1032	.038	.040	.250	.249	.340	.090	.280
		.054	.056					
1/4 - 20	0420	.054	.056	.344	.343	.440	.170	.340
		.087	.091					

Material	Description	Finish	Description
ST	Carbon Steel	Z	Zinc Clear

Custom sizes available.



All Dimensions are in Inches

NEL - Nuts

Self-Clinching, Locknut
Metric

Sample Part Number

NELST - M4 - 0.98 - Z
Series/ Thread Shank Finish
Material Code

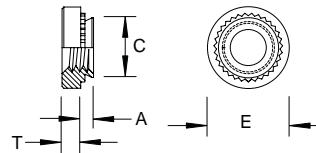

Thread	Thread Code	A Shank MAX	Sheet Thickness MIN	Hole Size in Sheet +0.08	C MAX	E ±0.25	T ±0.25	Dist. Hole C/L to Edge MIN
M3 x 0.5	M3	0.98	1	4.25	4.22	6.3	1.5	4.8
		1.38	1.4					
M3.5 x 0.6	M3.5	0.98	1	4.75	4.73	7.1	1.5	5.6
		1.38	1.4					
M4 x 0.7	M4	0.98	1	5.4	5.38	7.9	2	6.9
		1.38	1.4					
M5 x 0.8	M5	0.98	1	6.4	6.38	8.7	2	7.1
		1.38	1.4					
M6 x 1	M6	1.38	1.4	8.75	8.72	11.05	4.08	8.6
		2.21	2.3					

Material	Description	Finish	Description
ST	Carbon Steel	Z	Zinc Clear

Custom sizes available.

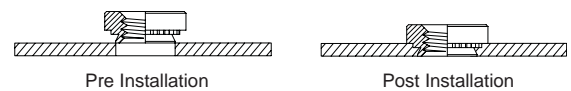

All Dimensions are in Metric