

## NDL - Nuts

Self-Clinching, Thick, Locking  
Inch

Sample Part Number

NDLST - 0420 - .058 - Z

Series/ Material	Thread Code	Shank Code	Finish

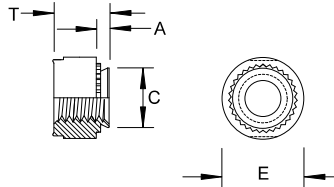

Thread	Thread Code	A Shank MAX	Sheet Thickness MIN	Hole Size in Sheet +.005/-.000	C MAX	E ±.010	T ±.010	Dist. Hole C/L to Edge MIN
1/4 - 20	2520	.058	.058	.344	.343	.500	.189	.380
5/16 - 18	3118	.058	.058	.413	.412	.575	.240	.420
3/8 - 16	3716	.058	.058	.500	.499	.650	.300	.480

Material	Description	Finish	Description
ST	Carbon Steel	Z	Zinc Clear

Custom sizes available.

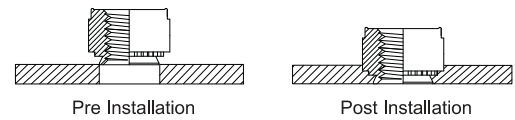

Revd. 06/1/11 All Dimensions are in Inches

## NDL - Nuts

Self-Clinching, Thick, Locking  
Metric

Sample Part Number

NDLST - M6 - 1.48 - Z

Series/ Material	Thread Code	Shank Code	Finish

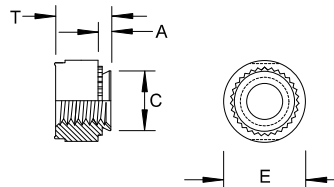

Thread	Thread Code	A Shank MAX	Sheet Thickness MIN	Hole Size in Sheet +0.13	C MAX	E ±0.25	T ±0.25	Dist. Hole C/L to Edge MIN
M6 x 1	M6	1.48	1.48	8.75	8.72	12.7	5	10
M8 x 1.25	M8	1.48	1.48	10.5	10.47	14.6	6.3	11
M10 x 1.5	M10	1.48	1.48	12.7	12.67	16.5	7.9	12

Material	Description	Finish	Description
ST	Carbon Steel	Z	Zinc Clear

Custom sizes available.

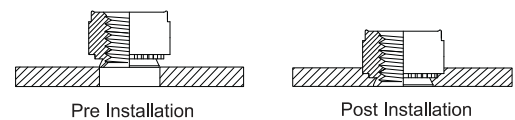

34

All Dimensions are in Metric