

NA - Nuts

Self-Clinching, Floating, Non-Locking
Inch

Sample Part Number

NASS - 440 - .038 - P
Series/ Thread Shank Finish
Material Code

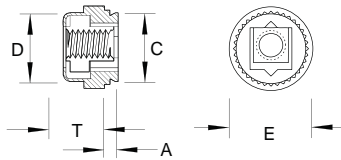

Thread	Thread Code	A Shank MAX	Sheet Thickness MIN	Hole Size in Sheet +.003/-0.000	C MAX	D MAX	E ±.015	T MAX	Dist. Hole C/Lto Edge MIN
4 - 40	440	.038	.040	.290	.289	.290	.36	.13	.30
		.054	.056						
6 - 32	632	.038	.040	.328	.327	.335	.39	.13	.32
		.054	.056						
8 - 32	832	.038	.040	.368	.367	.365	.44	.13	.34
		.054	.056						
10 - 24	1024	.038	.040	.406	.405	.405	.47	.17	.36
		.054	.056						
10 - 32	1032	.038	.040	.406	.405	.405	.47	.17	.36
		.054	.056						
1/4 - 20	0420	.054	.056	.515	.514	.510	.60	.21	.42
1/4 - 28	0428	.054	.056	.515	.514	.510	.60	.21	.42

Custom sizes available.

Material	Description	Finish	Description
ST	Carbon Steel	Z	Zinc Clear
SS	300 Series Stainless Steel	P	Passivate

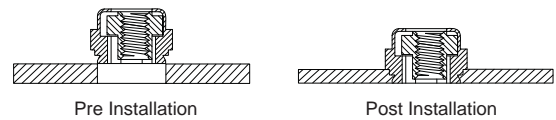

All Dimensions are in Inches

NA - Nuts

Self-Clinching, Floating, Non-Locking
Metric

Sample Part Number

NASS - M4 - 1.38 - P
Series/ Thread Shank Finish
Material Code

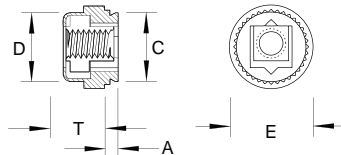

Thread	Thread Code	A Shank MAX	Sheet Thickness MIN	Hole Size in Sheet +0.08	C MAX	D MAX	E ±0.4	T MAX	Dist. Hole C/Lto Edge MIN
M3 x 0.5	M3	0.97	1	7.37	7.35	7.37	9.14	3.31	7.62
		1.38	1.4						
M4 x 0.7	M4	0.97	1	9.35	9.33	9.28	11.18	3.31	8.64
		1.38	1.4						
M5 x 0.8	M5	0.97	1	10.31	10.29	10.29	11.94	4.32	9.14
		1.38	1.4						
M6 x 1	M6	1.38	1.4	13.08	13.06	12.96	15.24	5.34	10.67

Custom sizes available.

Material	Description	Finish	Description
ST	Carbon Steel	Z	Zinc Clear
SS	300 Series Stainless Steel	P	Passivate

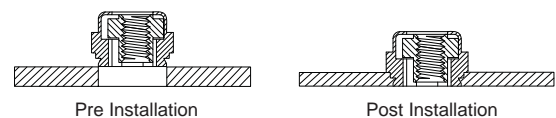

All Dimensions are in Metric