

# Nuts

## Machine Screw Nut

Inch

Sample Part Number

4 - 40 HX - MS - NU - STL - Z  
Thread Series Material Finish

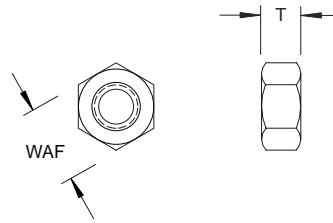

Thread		T Thickness	WAF Width Across Flats
Coarse	Fine		
-	0 - 80	.050 / .043	.156 / .150
-	1 - 72	.050 / .043	.156 / .150
2 - 56	-	.066 / .057	.188 / .180
4 - 40	-	.089 / .087	.250 / .241
6 - 32	-	.114 / .102	.312 / .302
8 - 32	-	.130 / .117	.344 / .332
10 - 24	10 - 32	.130 / .117	.375 / .362
12 - 24	-	.161 / .148	.438 / .423
1/4 - 20	1/4 - 28	.193 / .178	.438 / .423
5/16 - 18	5/16 - 24	.225 / .208	.562 / .545
3/8 - 16	3/8 - 24	.257 / .239	.625 / .607

Material	Description
STL	Low Carbon Steel
SS	18 - 8 Stainless Steel

Finish	Description
Z	Zinc Clear
Z - BLK	Zinc Black

Other finishes available.

Custom sizes available.

# Nuts

## Finished Hex Nut - Style 2

Metric

Sample Part Number

M3.5 HX - NU - STYLE2 - CL9 - Z - IFI  
Thread Series Material Finish Standard

ASME B18.2.4.1M

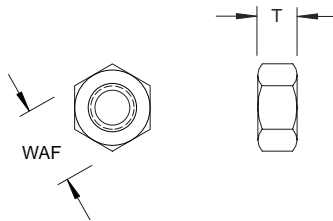

Thread	T Thickness	WAF Width Across Flats
M3 x 0.5	2.90 / 6.65	5.50 / 5.32
M3.5 x 0.6	3.30 / 3.00	6.00 / 5.83
M4 x 0.7	3.80 / 3.50	7.00 / 6.78
M5 x 0.8	5.10 / 4.80	8.00 / 7.78
M6 x 1.0	5.70 / 5.40	10.00 / 9.78
M8 x 1.25	7.50 / 7.14	13.00 / 12.73
M10 x 1.5	9.30 / 8.94	16.00 / 15.73
M12 x 1.75	12.00 / 11.57	18.00 / 17.73
M14 x 2	14.10 / 13.40	21.00 / 20.67
M16 x 2	16.40 / 15.70	24.00 / 23.67

Custom sizes available.

Material	Description
SS	18 - 8 Stainless Steel
CL9	Class 9 Steel
CL12	Class 12 Steel

Finish	Description
Z	Zinc Clear

Other finishes available.

Technical Data:

Property	Condition	Style of Hex Nut	Mating with Property Class
CL9	Non-Heat Treated	Style 2	9.8, 8.8, 4.8 and 4.6
CL12	Heat Treated		12.9, 10.9, 9.8, 8.8, 5.8, 4.8 and 4.6