

Nuts

Flange Top Locknut Inch

Sample Part Number

1/4 - 20 HX - FLANGE - TLK - NU - STL - Z
Thread Series Material Finish

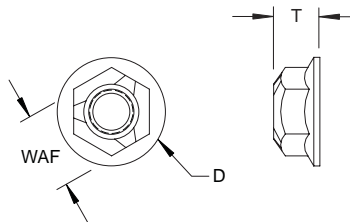

Thread		T Thickness	D Diameter	WAF Width Across Flats
Coarse	Fine			
6 - 32	-	.171 / .156	.442 / .406	.312 / .302
8 - 32	-	.203 / .187	.469 / .452	.344 / .334
10 - 24	10 - 32	.219 / .203	.500 / .480	.375 / .365
1/4 - 20	1/4 - 28	.236 / .222	.594 / .574	.438 / .428
5/16 - 18	5/16 - 24	.283 / .268	.680 / .660	.500 / .489
3/8 - 16	3/8 - 24	.347 / .330	.750 / .728	.562 / .551
7/16 - 14	7/16 - 20	.395 / .375	.937 / .910	.688 / .675
1/2 - 13	1/2 - 20	.458 / .437	1.031 / 1.000	.750 / .736
5/8 - 11	5/8 - 18	.569 / .545	1.281 / 1.248	.938 / .922
3/4 - 10	3/4 - 16	.675 / .627	1.500 / 1.460	1.125 / 1.088

Custom sizes available.

Material	Description
STL	Low Carbon Steel
SS	18 - 8 Stainless Steel

Finish	Description
Z	Zinc Clear
Z - BLK	Zinc Black

Other finishes available.

Nuts

Prevailing-Torque Flange Nut Metric - Steel Property Class 5 and 9

Sample Part Number

M3 PREV - TORQ - FLANGE - STL - Z - IFI
Thread Series Material Finish Standard

ASME B18.16.3M

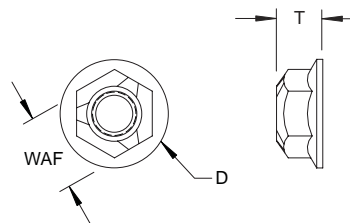

Thread	T Thickness	D Flange Diameter	WAF Width Across Flats	Prevailing-Torque, N-M (in. lb) Classes 5 and 9		
				1st Install. MAX	1st Removal MIN	5th Removal MIN
M6 x 1	7.30 / 5.70	14.2	10.00 / 9.78	3.0	0.45	0.30
M8 x 1.25	9.40 / 7.60	17.9	13.00 / 12.73	7.0	0.85	0.60
M10 x 1.5	11.40 / 9.60	21.8	15.00 / 14.73	10.5	1.5	1.0
M12 x 1.75	13.80 / 11.60	26.0	18.00 / 17.73	15.5	2.3	1.6
M14 x 2	15.90 / 13.30	29.9	21.00 / 20.67	24	3.3	2.3
M16 x 2	18.30 / 15.30	34.5	24.00 / 23.67	32	4.5	3.0
M20 x 2.5	22.40 / 18.90	42.8	30.00 / 29.16	54	7.5	5.3

Custom sizes available.

Material	Description
STL	Low Carbon Steel
SS	18 - 8 Stainless Steel

Finish	Description
Z - BLK	Zinc Black
Z	Zinc Clear

Other finishes available.