

# Nuts

## Finished Hex Nut Inch

Sample Part Number

1/4 - 20 HX - NU - STL - Z  
Thread Series Material Finish

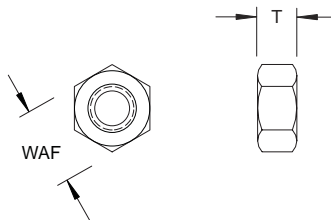

Thread		T Thickness	WAF Width Across Flats
Coarse	Fine		
1/4 - 20	1/4 - 28	.226 / .212	.438 / .428
5/16 - 18	5/16 - 24	.273 / .258	.500 / .489
3/8 - 16	3/8 - 24	.337 / .320	.562 / .551
7/16 - 14	7/16 - 20	.385 / .365	.688 / .675
1/2 - 13	1/2 - 20	.448 / .427	.750 / .736
9/16 - 12	9/16 - 18	.496 / .473	.875 / .861
5/8 - 11	5/8 - 18	.559 / .535	.938 / .922
3/4 - 10	3/4 - 16	.665 / .617	1.125 / 1.088

Material	Description
STL	Low Carbon Steel
SS	18 - 8 Stainless Steel

Finish	Description
Z	Zinc Clear
Z - BLK	Zinc Black

Other finishes available.

Custom sizes available.

# Nuts

## Finished Hex Nut - Style 1 Metric

Sample Part Number

M3 HX - NU - STYLE1 - CLS - Z - IFI  
Thread Series Material Finish Standard

ASME B18.2.4.1M

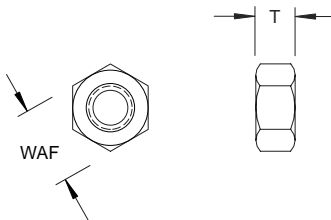

Thread	T Thickness	WAF Width Across Flats
M1.6 x 0.35	1.30 / 1.05	3.20 / 3.02
M2 x 0.4	1.60 / 1.35	4.00 / 3.82
M2.5 x 0.45	2.00 / 1.75	5.00 / 4.82
M3 x 0.5	2.40 / 2.15	5.50 / 5.32
M3.5 x 0.6	2.80 / 2.55	6.00 / 5.82
M4 x 0.7	3.20 / 2.90	7.00 / 6.78
M5 x 0.8	4.70 / 4.40	8.00 / 7.78
M6 x 1.0	5.20 / 4.90	10.00 / 9.78
M8 x 1.25	6.80 / 6.44	13.00 / 12.73
M10 x 1.5	8.40 / 8.04	16.00 / 15.73

Material	Description
SS	18 - 8 Stainless Steel
CL5	Class 5 Steel
CL10	Class 10 Steel

Finish	Description
Z	Zinc Clear

Other finishes available.

Technical Data:

Property	Condition	Style of Hex Nut	Mating with Property Class
CL5	Non-Heat Treated	Style 1	5.8, 4.8 and 4.6
CL10	Heat Treated		10.9, 9.8, 5.8, 4.8 and 4.6

Custom sizes available.