

Nuts

Cap Nut Inch

Sample Part Number

10 - 32 HX - CAP - NU - STL - Z
Thread Series Material Finish

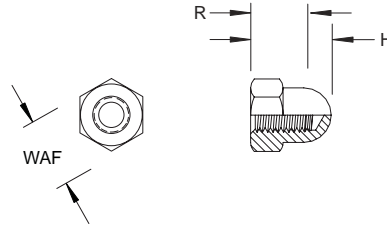

Thread	H Height REF	WAF Width Across Flats	R Full Thread MIN
6 - 32	.34	.3125 / .302	.16
8 - 32	.34	.3125 / .302	.16
10 - 32	.41	.3750 / .362	.19
1/4 - 20	.47	.4375 / .428	.25
5/16 - 18	.53	.5000 / .489	.31
3/8 - 16	.62	.5625 / .551	.38
1/2 - 13	.81	.7500 / .736	.50
5/8 - 11	1.00	.9375 / .922	.62
3/4 - 10	1.16	1.0625 / 1.045	.75

Custom sizes available.

Material	Description
STL	Low Carbon Steel
SS	18 - 8 Stainless Steel

Finish	Description
Z	Zinc Clear
Z - BLK	Zinc Black

Other finishes available.

Nuts

Cap Nut Metric

Sample Part Number

M3 HX - CAP - NU - STL - Z - DIN 1587
Thread Series Material Finish Standard

DIN 1587

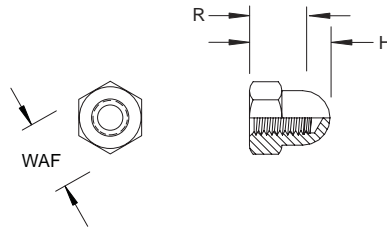

Thread	H Height REF	R Height REF	WAF Width Across Flats REF
M3 x 0.5	6	3	5.5
M4 x 0.7	8	4	7
M5 x 0.8	10	5	8
M6 x 1	12	5	10
M8 x 1.25	15	6.5	13
M10 x 1.50	18	8	17
M12 x 1.75	22	10	19
M16 x 2	28	13	24
M20 x 2.5	34	16	30
M24 x 3	42	19	36

Custom sizes available.

Material	Description
STL	Low Carbon Steel
SS	18 - 8 Stainless Steel

Finish	Description
Z	Zinc Clear

Other finishes available.